

Ⓐ x1

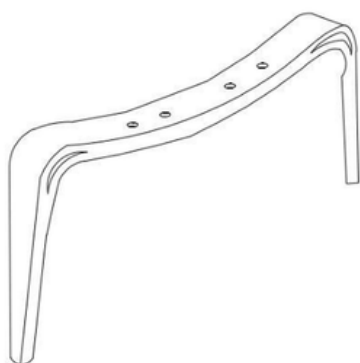

Ⓑ x1

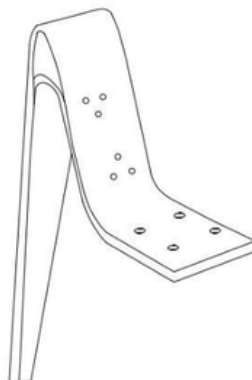

Ⓒ x1

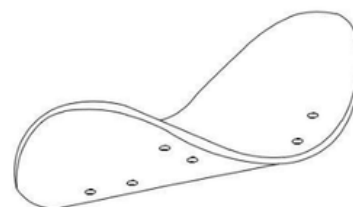

Ⓓ x1

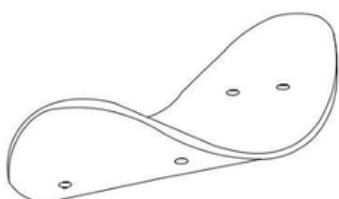

Ⓔ x1

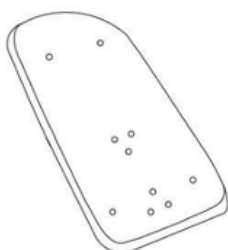

Ⓕ x1



Ⓖ x1

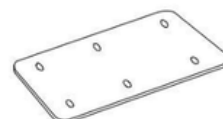

Ⓕ x6



Ⓖ x7



Ⓗ x15

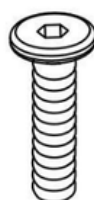

Ⓙ x1

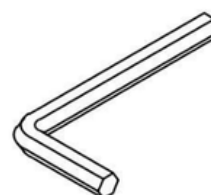

Step1

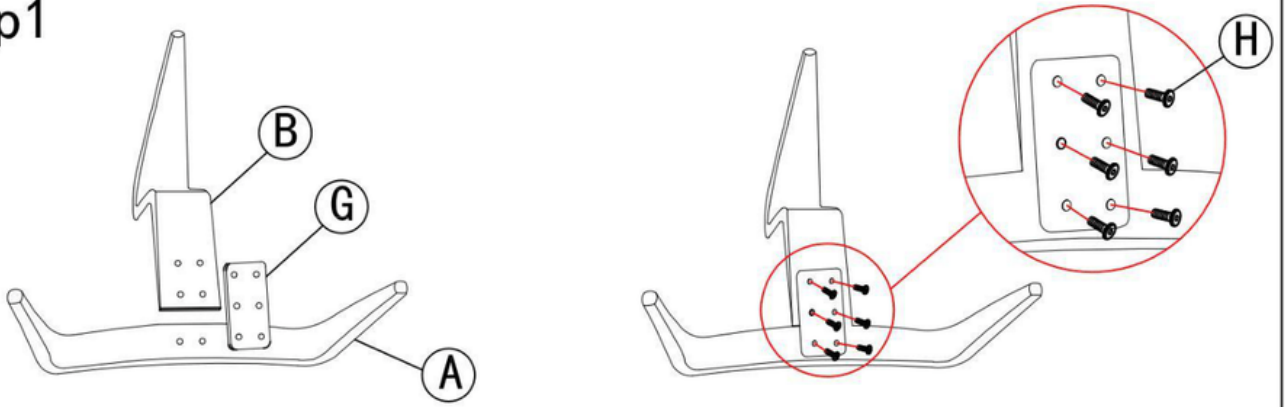

Step2

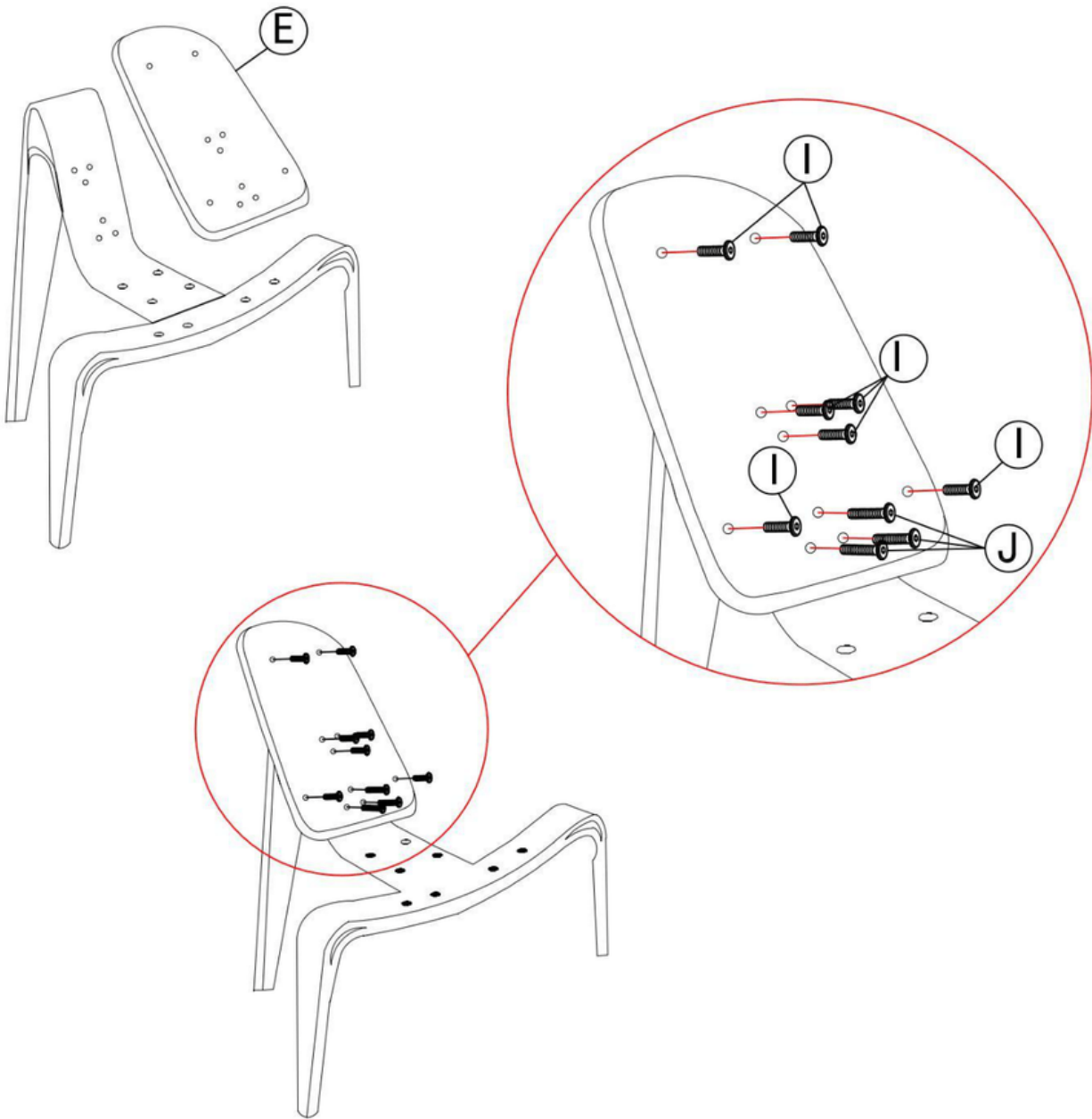

Step3

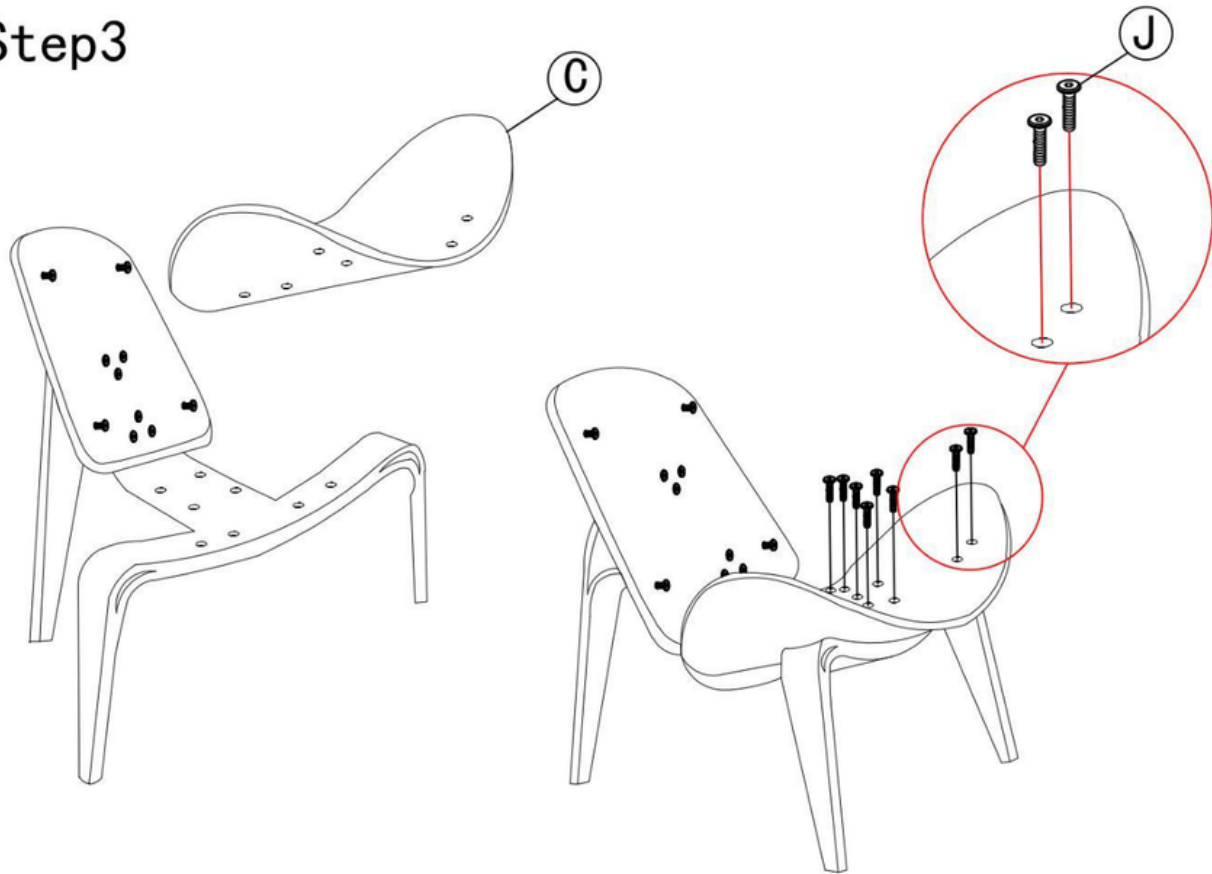

Step4

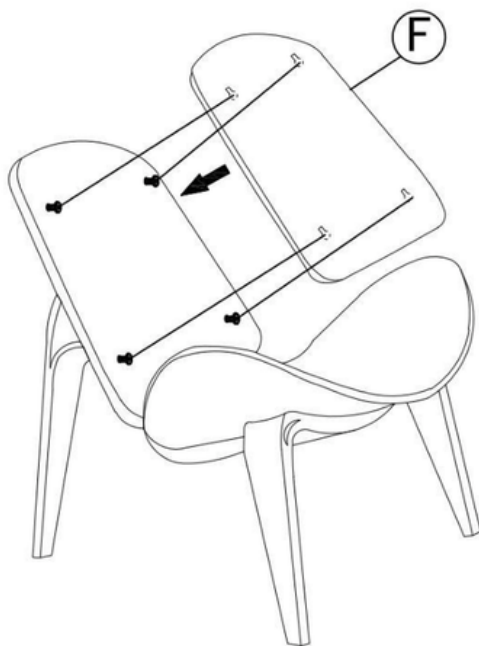

Use the four holes on the back of F to align the four screws on E and hang them up



Step 5

